

SUPERB NEXT GENERATION FABRIC DISPLAY SOLUTIONS

www.fabricpopup.com

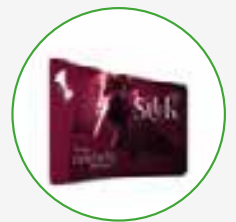

WHERE FORM MEETS FUNCTION

Fabric Displays available in various widths and configurations, shaped Counters, impressive Retail Displays and Exhibition & Hanging structures. The range also includes custom designed accessories including shelving and literature holders.

Contents page

Instructions	2-3
Fabric Displays	4-5
Counters	6-9
Retail Displays	10-11
Exhibition & Hanging Structures	12-13
Accessories	14-17
Printing & Finishing	18

www.fabricpopup.com | 0345 470 0845

Each structure is manufactured from **lightweight** yet **strong** 32mm diameter aluminium tubing making the kit very **portable** and easy to carry.

Attaching the graphics is simple! Each graphic **effortlessly slides** over the framework and zips closed.



Each of the connecting frame sections are **clearly labelled** with matching symbols and certain sections are joined together with bungee cord, meaning that it is **easy to assemble** and saves time compared with other types of display equipment.



No need to worry about accidentally creating the graphics; the elasticity within the fabric makes them **extremely durable**. Therefore, the **graphics are long lasting** and give a **great return on investment**.



Graphics are easy to care for. After use, zip closed, fold up and place into the bag. If the graphics get dirty during use they can be washed (machine washable at 30°C, do not iron)



Each product is supplied with a standard **carry bag** for easy transportation and storage. Lighting and other accessories are also available.

HOW TO ASSEMBLE

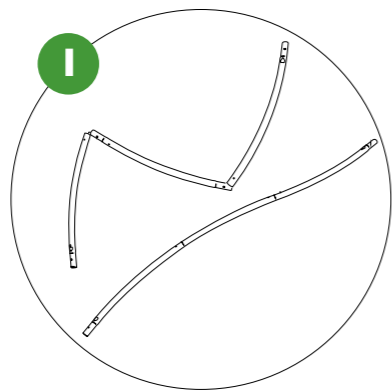

Lay out all components and connect bungee poles.

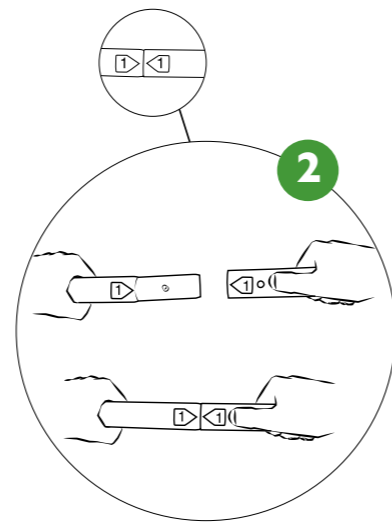

Match the same numbers and colours together.

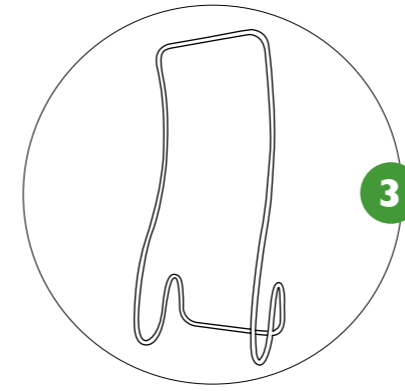

Connect all the parts until you have created the completed shape.

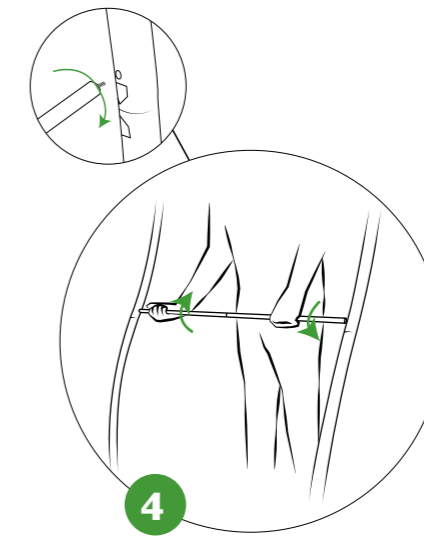

Optional step

Add support brace when instructed.

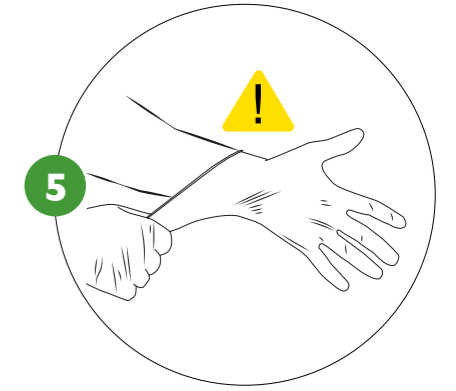

Make sure you have a clean surface and hands. Cotton gloves are provided.

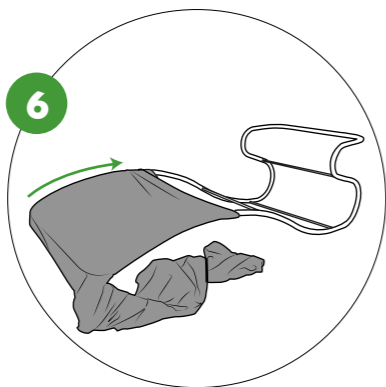

Place the fabric graphic sock over the Formulate shape making sure the graphics are the correct way round.

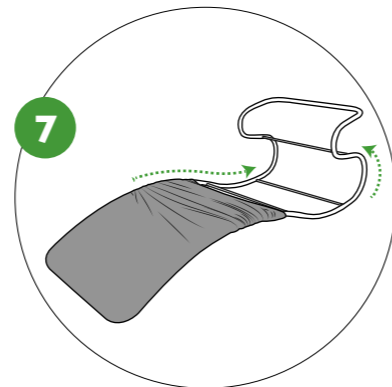

Gently pull graphics completely over the frame until you have a straight snug fit.

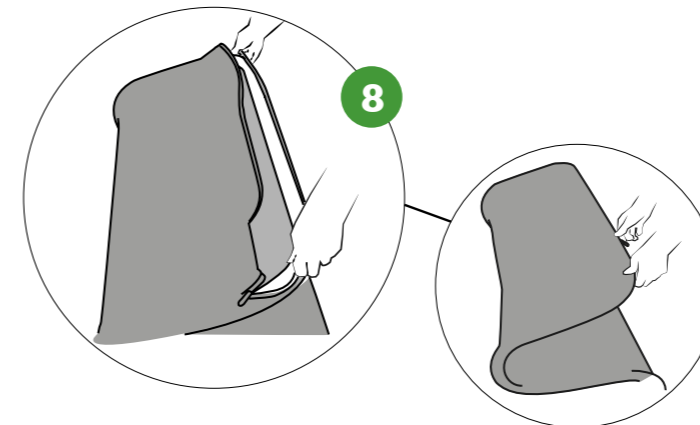

Pull the graphics together at the bottom of the tubing and zip up.



All products include a carry bag

Fabric Displays

Choose from a wide range of fabric displays to set the back drop for your creation. Design stunning graphics to wow your customers.

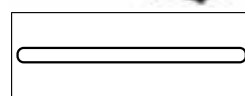
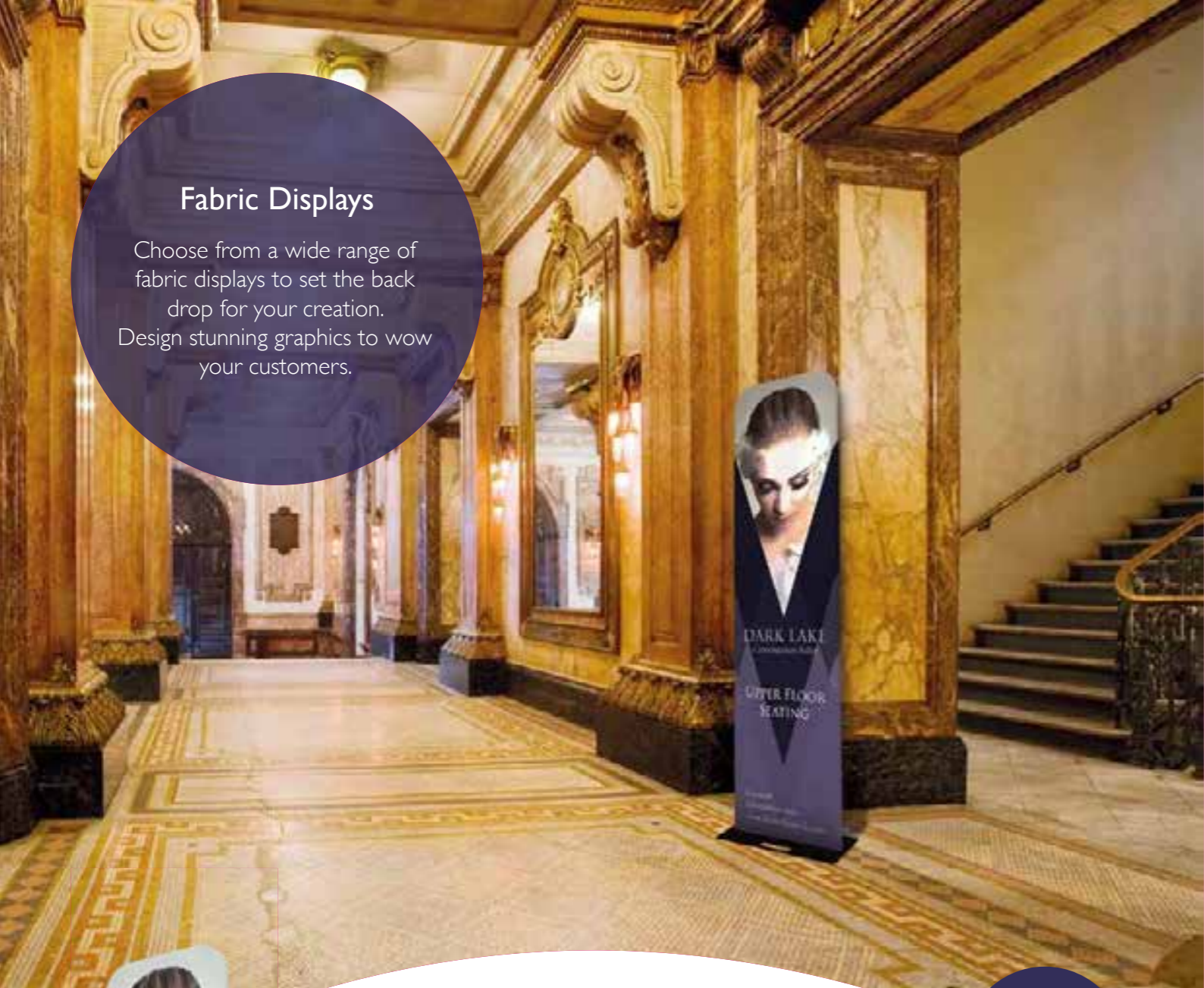

Plan view



Monolith Fabric Display

Total hardware dimensions (approx): (h) x (w) x (d) mm

- 600mm**
(FMSS-VSS-01): 2280 x 650 x 250mm
- 900mm**
(FMSS-VSS-02): 2280 x 955 x 250mm
- 1200mm**
(FMSS-VSS-03): 2280 x 1240 x 250mm
- 1500mm**
(FMSS-VSS-04): 2280 x 1544 x 250mm

⌚
Approx. assembly time
5 mins

www.fabricpopup.com



Plan view

Straight Fabric Display

Total hardware dimensions (approx): (h) x (w) x (d) mm

- 0.9m**
(FMLT-SLS-01): 2280 x 955 x 360mm
- 2.4m**
(FMLT-SLS-02): 2280 x 2438 x 480mm
- 3.0m**
(FMLT-SLS-03): 2280 x 3048 x 480mm
- 6.1m**
(FMLT-SLS-04): 2280 x 6096 x 480mm



Plan view

Curved Fabric Display

Total hardware dimensions (approx): (h) x (w) x (d) mm

- 2.4m**
(FMLT-CLS-01): 2280 x 2438 x 420mm
- 3.0m**
(FMLT-CLS-02): 2280 x 3048 x 538mm
- 6.1m**
(FMLT-CLS-03): 2280 x 6096 x 700mm



Plan view

Serpentine Fabric Display

Total hardware dimensions (approx): (h) x (w) x (d) mm

- 2.4m**
(FMLT-SSS-01): 2280 x 2438 x 420mm
- 3.0m**
(FMLT-SSS-02): 2280 x 3048 x 444mm
- 6.1m**
(FMLT-SSS-03): 2280 x 6096 x 830mm

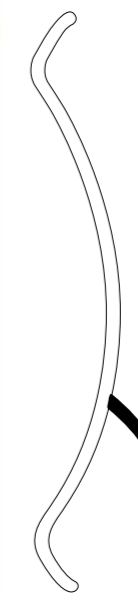

Side view

Vertical Curve Fabric Display

Total hardware dimensions (approx): (h) x (w) x (d) mm

- 3.0m**
(FMLT-USS-01): 2280 x 3048 x 583mm
- 6.1m**
(FMLT-USS-02): 2280 x 6096 x 583mm

⌚
Approx. assembly time
5-10 mins

All Formulate products include a carry bag



**Curved Slope
Fabric Display**

Total hardware dimensions
(approx): (h) x (w) x (d) mm

3.0m
(FMLT-CSS-OS01): 2280-1830 x 3048 x 538mm

6.1m
(FMLT-CSS-OS02): 2280-1830 x 6096 x 700mm

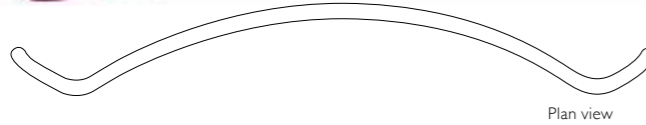

Plan view



**Serpentine Slope
Fabric Display**

Total hardware dimensions
(approx): (h) x (w) x (d) mm

3.0m
(FMLT-SSS-OS01): 2280-1830 x 3048 x 444mm

6.1m
(FMLT-SSS-OS02): 2280-1830 x 6096 x 830mm

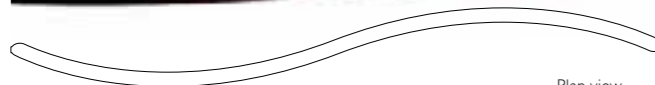

Plan view

⌚
Approx.
assembly time
5-10 mins



**Straight Slope
Fabric Display**

Total hardware dimensions
(approx): (h) x (w) x (d) mm

3.0m
(FMLT-SLS-OS01): 2280-1830 x 3048 x 480mm

6.1m
(FMLT-SLS-OS02): 2280-1830 x 6096 x 480mm

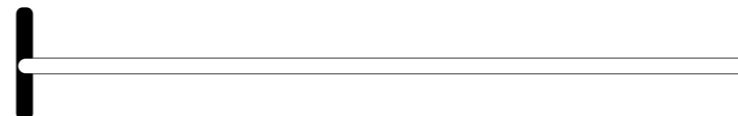

Counters

Complete your display with a Formulate Counter where you can welcome your guests. Choose from a range of shapes and sizes, some even come with display shelving for extra impact.



Oval Counter

Total hardware dimensions (approx): (h) x (w) x (d) mm

Oval Counter
(FMC-OVA-01): 1015 x 595 x 395mm

Maximum load: 50kg evenly distributed

Oval Counter shelving display
(FMC-ORS-01): 1980 x 595 x 395mm

Maximum load: 50kg evenly distributed
Shelving: 6mm thick frosted acrylic (595 x 395mm)

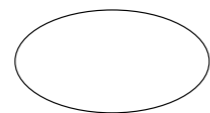

Plan view

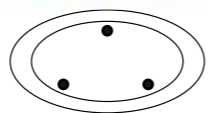

Plan view



Plan view

Rectangle Counter

Total hardware dimensions (approx): (h) x (w) x (d) mm

(FMC-SQA-01): 1015 x 800 x 530mm

Maximum load: 50kg evenly distributed



Plan view

Large Rectangle Counter

Total hardware dimensions (approx): (h) x (w) x (d) mm

(FMC-SQA-02): 1015 x 1880 x 520mm

Maximum load: 50kg evenly distributed



Retail Displays

There is a choice of free-standing shapes including tablet holders, ideal for retail or hospitality environments.

Add double sided graphics to make sure passers by see your message from all directions.



Approx. assembly time
12 mins

Drum Retail Display

Total hardware dimensions (approx): (h) x (w) x (d) mm

(FMDC-3DC-01) 2280 x 2500 x 400mm



Side view



Snake Retail Display

Total hardware dimensions (approx): (h) x (w) x (d) mm

(FMSS-VS-01) 2280 x 915 x 700mm



Slant Retail Display

Total hardware dimensions (approx): (h) x (w) x (d) mm

(FMSS-VS-02) 2280 x 915 x 650mm



Curl Retail Display

Total hardware dimensions (approx): (h) x (w) x (d) mm

(FMSS-VS-03) 2280 x 915 x 480mm



Z Table Retail Display

Total hardware dimensions (approx): (h) x (w) x (d) mm

(FMLT-TS-01) 1000 x 550 x 550mm

Table top size 550 x 550mm

Maximum load: 30kg evenly distributed



iPad Stand Retail Display

Total hardware dimensions (approx): (h) x (w) x (d) mm

(FMLT-IP-01) 1320 x 385 x 560mm

Suitable for all iPads except Mini



Approx. assembly time
5-8 mins

All Formulate products include a carry bag

Exhibition & Hanging Structures

For the ultimate wow factor at your indoor show or event choose Hanging Structures to provide strong visual impact.

Included in the range are impressive free-standing arches, an eye-catching meeting pod, or be seen from afar with ceiling suspended hanging structures.



Approx. assembly time **10-20 mins**

Circle Hanging Structure

Total hardware dimensions (approx): (h) x (dia) mm

1.5 x 0.8m (FMHS-RIN-01):	762 x Ø1524mm
3.0 x 0.6m (FMHS-RIN-02):	610 x Ø3048mm
3.0 x 0.9m (FMHS-RIN-03):	914 x Ø3048mm
4.6 x 1.5m (FMHS-RIN-04):	1524 x Ø4572mm
6.1 x 1.2m (FMHS-RIN-05):	1219 x Ø6096mm

www.fabricpopup.com | 0345 470 0845



Tapered Hanging Structure

Total hardware dimensions (approx): (h) x (dia) mm

3-2.4 x 1.1m (FMHS-TC-01):	1067 x Ø3048-2438
4.3-3.7 x 1.2m (FMHS-TC-02):	1219 x Ø4267-3658
4.6-3.4 x 1.2m (FMHS-TC-03):	1219 x Ø4572-3962



Eye Hanging Structure

Total hardware dimensions (approx): (h) x (w) x (d) mm

3.0 x 1.2m (FMHS-EYE-02):	1219 x 3048 x 838mm
3.7 x 1.5m (FMHS-EYE-03):	1524 x 3658 x 991mm



Triangle Hanging Structure

Total hardware dimensions (approx): (h) x (w) x (d) mm

4.3 x 1.1m (FMHS-TRI-02):	1067 x 4267 x 4267mm*
6.1 x 1.1m (FMHS-TRI-03):	1067 x 6096 x 6096mm*

*4267 / 6096mm refers to the width of each side of the triangular structure



Triplet Hanging Structure

Total hardware dimensions (approx): (h) x (w) x (d) mm

3.0 x 0.9m (FMHS-PIN-01):	914 x 3048 x 3048mm*
4.3 x 1.5m (FMHS-PIN-02):	1524 x 4267 x 4267mm*
4.9 x 1.5m (FMHS-PIN-03):	1524 x 4877 x 4877mm*

*3048 / 4267 / 4877mm refers to the width of each side of the Triplet structure.



Square Hanging Structure

Total hardware dimensions (approx): (h) x (w) x (d) mm

2.4 x 1.1m (FMHS-SQU-01):	1067 x 2438 x 2438mm
3.0 x 1.2m (FMHS-SQU-02):	1219 x 3048 x 3048mm
4.9 x 1.2m (FMHS-SQU-03):	1219 x 4877 x 4877mm
6.1 x 1.2m (FMHS-SQU-04):	1219 x 6096 x 6096mm



Rectangle Hanging Structure

Total hardware dimensions (approx): (h) x (w) x (d) mm

(FMHS-REC-01):	1219 x 3658 x 2438mm
----------------	----------------------



Approx. assembly time **10-20 mins**

All Formulate products include a carry bag

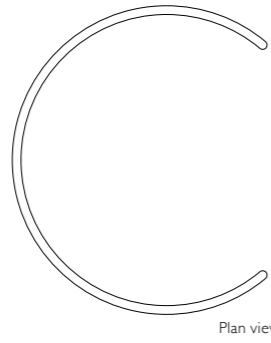

Plan view

Meeting Pod

Total hardware dimensions (approx): (h) x (w) x (d) mm

(FMLT-SC-01) 2280-1219 x 3000 x 2495mm

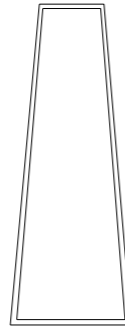

Side view

2.7m Arch

Total hardware dimensions (approx): (h) x (w) x (d) mm

2.7m (FMLT-ARC-01) 2300 x 2700 x 1000mm

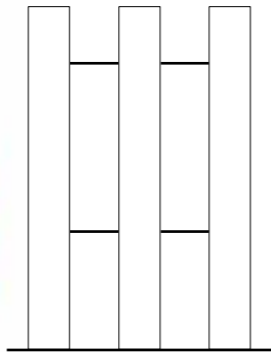

Side view

6m Arch (Triple)

Total hardware dimensions (approx): (h) x (w) x (d) mm

6m (FMLT-ARC-03) 3975 x 6000 x 5000mm

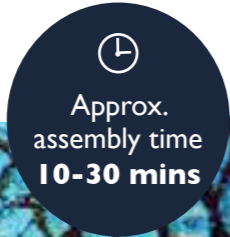

Approx. assembly time 10-30 mins



6m Arch

Total hardware dimensions (approx): (h) x (w) x (d) mm

6m (FMLT-ARC-02) 3975 x 6000 x 1000mm



Approx. assembly time 10-20 mins

ACCESSORIES

Accessorise your display with the specially designed accessory kit.



FMLT158-32 (32mm diam. Pole)



1.5kg approx. evenly distributed
More than one shelf can be used*

*Caution: Overloading may cause instability. Always check that the stand is stable before adding additional accessories



*Suitable for all iPads except the mini iPad



Sizes available for Literature Holder A5, A4 & DL

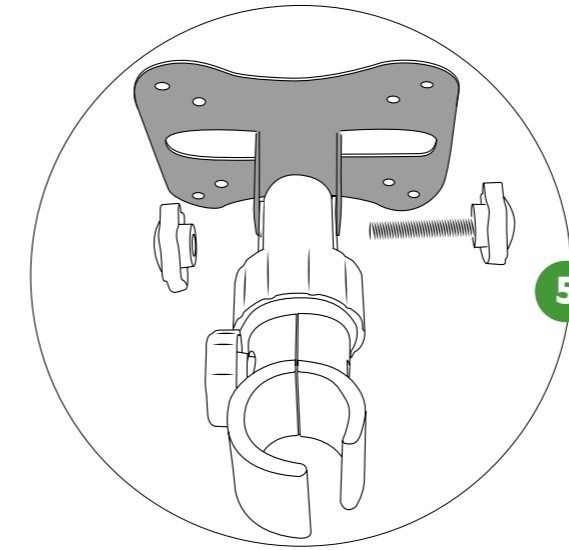

How to attach accessory onto the Universal Clamp

Align the holes of the bracket onto the holes on the insert moulding then tighten with black thumb wheel. Adjust to suit.

How to fit Universal Accessory

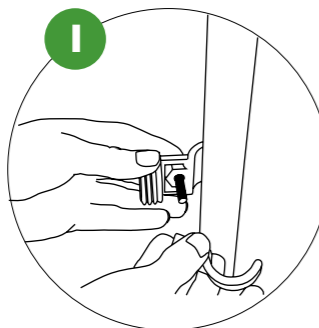

Position clamp around tubing.

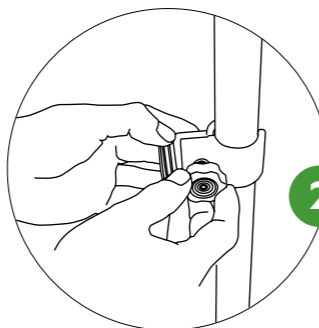

Once in desired place tighten with the thumb wheel.

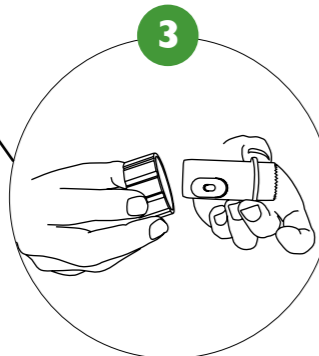
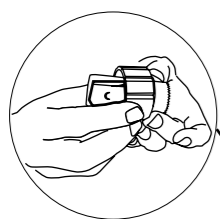

Put the collar through the fitting insert.

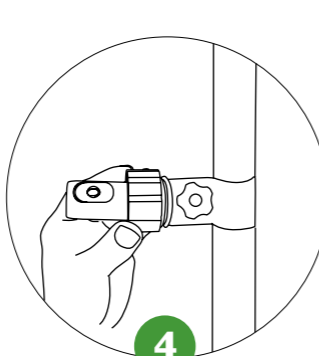

Tighten the collar to the clamp as shown.

PRINTING & FINISHING

Specialist printing and finishing skills are required to create the best looking display products

We offer a wide range of printing, cutting and finishing techniques to include UV, Dye-sub and latex printing, plus digital cutters and expert sewing machinists to give a top-class professional finish.

Using high quality, high stretch media you can create the most impressive displays around.



Laser-cutting



Dye-sub, UV, latex and screen printing available



SUPERB NEXT GENERATION FABRIC DISPLAY SOLUTIONS

www.fabricpopup.com